

CENTRIFUGAL PUMPS

FRAME MOUNT 13"



FEATURES

- Volute: Cast iron for heavy-duty service; back pullout design; can be rotated for ease of installation; 6x8 has a split case volute for reduction in radial bearing load
- Impeller: Enclosed design for high efficiency; configured for superior NPSH characteristics; internally hydraulically balanced for reduced axial bearing load
- Seal: Packed box with lantern ring or mechanical seal with carbon ceramic faces, nitrile elastomers, and 300 series stainless steel components
- Bearing Frame: Heavy-duty iron with oversized shaft and max-life bearings; grease lubrication
- Power Frame: Heavy-duty iron with oversized shaft and max-life bearings; double-keyed impeller
- Mounting: Vertical or horizontal
- Replaceable shaft sleeve and bronze wear rings
- Casing and frame jack-out holes; frame and volute lifting bosses
- Two-piece stainless steel packing gland

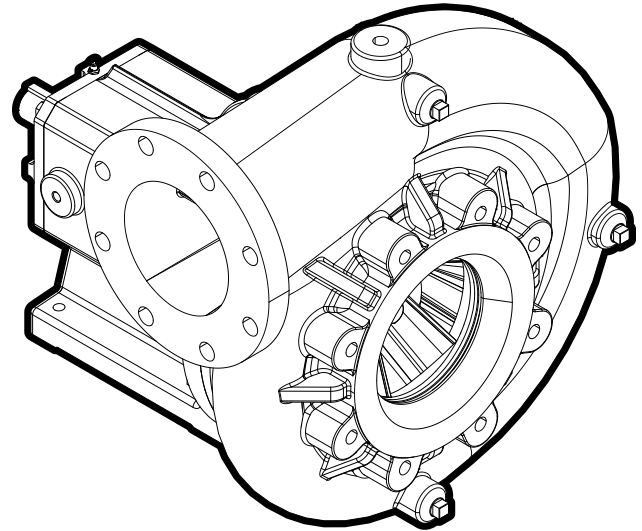

SPECIFICATIONS

- Capacities to 2800 gpm
- Heads to 360 feet
- 350 psi maximum working pressure
- 212 °F maximum temperature
- Clockwise rotation when viewed from motor end
- Class 150 flanged pipe connections

Discharge	Suction
3"	4"
4"	6"
6"	8"

APPLICATIONS

- Irrigation
- Commercial
- Construction
- Municipal
- Mining
- Industrial

CENTRIFUGAL PUMPS

FRAME MOUNT 13"



ORDERING INFORMATION

Pump Model	Rotation	Shaft Sealing	Model Description	Order No.	Wt. (lbs)	Basic Model	PEI _{CL} Number
3 x 4 - 13	CW	Packing	XS4313-BFP-CW	64040313102	277	XS4313-BF	0.99
		Mechanical Seal	XS4313-BFM-CW	65040313102			
4 x 6 - 13H		Packing	XS6413H-BFP-CW	64060413104	294	XS6413-BF	0.98
		Mechanical Seal	XS6413H-BFM-CW	65060413104			
6 x 8 - 13		Packing	XS8613-BFP-CW	64080613102	390	XS8613-BF	0.97
		Mechanical Seal	XS8613-BFM-CW	65080613102			

NOTE: There will be an impeller trimming charge applied for any non-standard impeller trim; consult price sheets for list price adders; FKM seals available

CENTRIFUGAL PUMPS

FRAME MOUNT 13"



DIMENSIONS

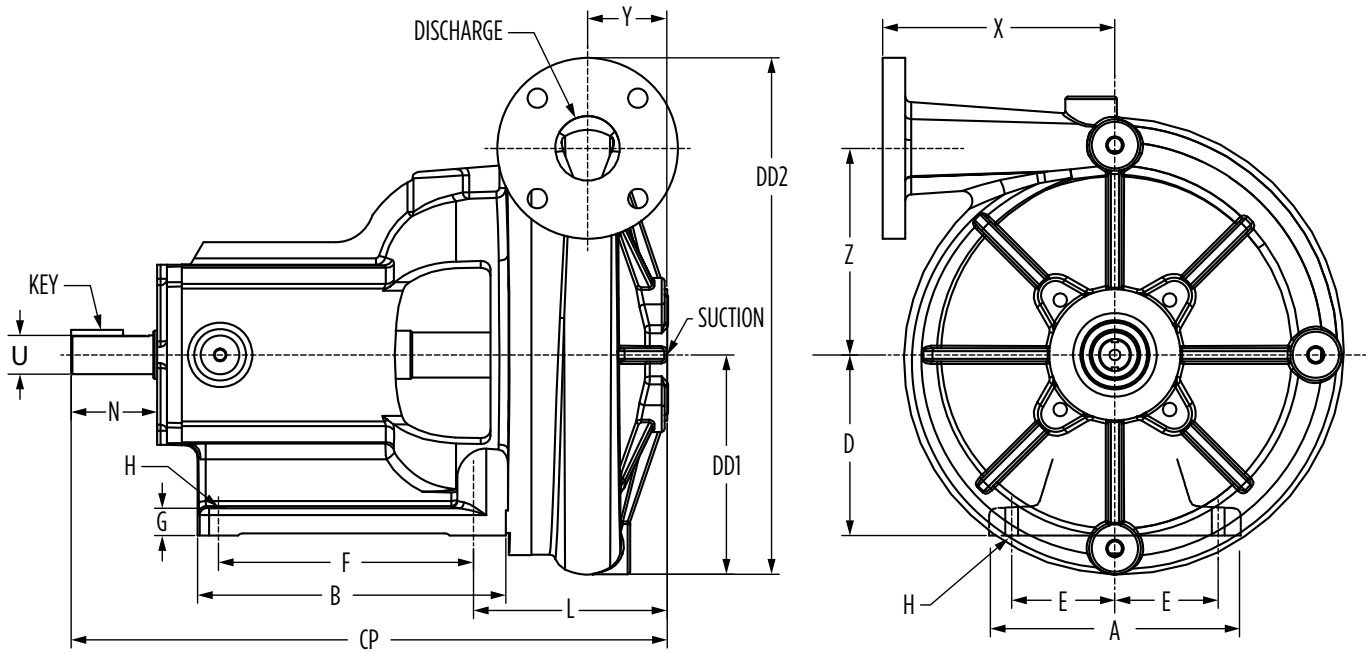

Model	Dimensions (in)																
	A	B	D	E	F	G	H	L	N	U	X	Y	Z	CP	DD1	DD2	Key
3 x 4 - 13	9.75	12.00	7.00	4.00	9.87	1.50	0.50	7.62	3.32	1.50	9.00	3.00	8.00	23.25	8.87	20.62	.37
4 x 6 - 13H	9.75	12.00	7.00	4.00	9.87	1.50	0.50	7.87	3.32	1.50	9.00	3.00	7.50	23.50	8.75	20.75	.37
6 x 8 - 13	9.75	12.00	7.00	4.00	9.87	1.50	0.50	9.00	3.32	1.50	12.00	4.00	8.75	24.62	10.25	24.37	.37

NOTE: Dimensions are for estimating purposes only

CENTRIFUGAL PUMPS

FRAME MOUNT 13"



MATERIALS AND PARTS

Fig.	Part Description	Part No.				Materials
		XS25x3-13	XS3x4-13	XS4x6-13H	XS6x8-13	
1	Volute Case	305464034	305464001	305464017	305464018	Cast iron, ASTM-48 Class 30
2	Impeller	-	305464002	305464063	305464021	316 Stainless steel
4A	Wear Ring, Volute Case	305464036	305464003	305464023	305464024	SAE 660 bronze
4B	Wear Ring, Seal Plate		305464003		305464025	SAE 660 bronze
5	Pump Shaft (only available in shaft kit)		See Shaft Kit			Stressproof® AISI 1144
6	Bearing Frame		305464004			Cast iron, ASTM-48 Class 30
9	Bearing Frame Cover		305464005			Cast iron, ASTM-48 Class 30
10	Mechanical Seal Back Plate		305464006		305464026	Cast iron, ASTM-48 Class 30
11	Packing Seal Back Plate		305464007		305464027	Cast iron, ASTM-48 Class 30
12A	Packing Shaft Sleeve		305464008		305464028	416 Stainless steel
12B	Mechanical Seal Shaft Sleeve		305464009		305464029	416 Stainless steel
13	Packing Ring Set		305731918			Graphite/cotton
14	Lantern Ring		305464011			Acetal
15	Packing Gland (2 piece)		305464012			316 Stainless steel
16	Bearing, Pump Side		305463145			Steel
17	Bearing, Drive Side		305463146			Steel
18	Flat Socket Cap Screw, Seal Plate (8 pack)		305463147			300 Series stainless steel
20	Mechanical Seal Assembly		305464013		305464030	Misc.
21	Packing Gland Assembly		305464014		305464031	Misc.
26	Lip Seal, Pump/Drive Side		305463148			Nitrile
30	Mechanical Seal Retaining Ring		305463149			316 Stainless steel
35	Shaft Key, Impeller (2 pack)		305463150		305464032	316 Stainless steel
42	Bearing Thrust Ring		305463151			Carbon steel
43	Bearing Snap Ring		305463152			316 Stainless steel
90	Mechanical Shaft Seal		305463153			Carbon/ceramic/nitrile/316 stainless steel
100	O-ring, Volute Case		305463154			Nitrile
503	Water Slinger		305464015			Neoprene
510	Hex Cap Screw, Impeller		305463155		305463167	316 Stainless steel, grade 5
520	Washer, Impeller		305464016		305464033	300 Series stainless steel
525	Lock Washer, Impeller		305463156		305463168	316 Stainless steel
529	Nut, Packing Gland (4 pack)		305463157			Zinc-plated steel
531	Stud, Packing Gland (2 pack)		305463158			Zinc-plated steel
540	Flat Socket Cap Screw, Seal (8 pack)		305463159			Nylon
500A	Pipe Plug (4 pack)	305463175		305463144	305463175	CAD-plated steel
502A	Grease Zerk, Straight (3 pack)		305463160			CAD-plated steel
502B	Grease Zerk, 65 Deg.		305463161			CAD-plated steel
530A	Hex Cap Screw, Bearing Cover (4 pack)		305463162			Zinc-plated steel, grade 5
530B	Hex Cap Screw, Volute Case (8 pack)		305463163			Zinc-plated steel, grade 5
533A	Hex Cap Lock Washer, Bearing Cover (4 pack)		305463164			Zinc-plated steel
533B	Hex Cap Lock Washer, Volute Case (8 pack)		305463067			Zinc-plated steel
Not Shown	Set Screw, Mechanical Sleeve		305463165			300 Series stainless steel
Not Shown	Shaft Key, Drive Side		305463166			300 Series stainless steel
Not Shown	Shaft Kit Seal (Includes 5, 12, 16, 17, 35, 42, 43)		305731908		305731914	Misc.
Not Shown	Shaft Kit Pack (Includes 5, 12, 16, 17, 35, 42, 43)		305731907		305731913	Misc.

NOTES

FRAME MOUNT 13"



NOTES

FRAME MOUNT 13"





Franklin Electric